

LOCATION & COMMON PROPERTY PLAN

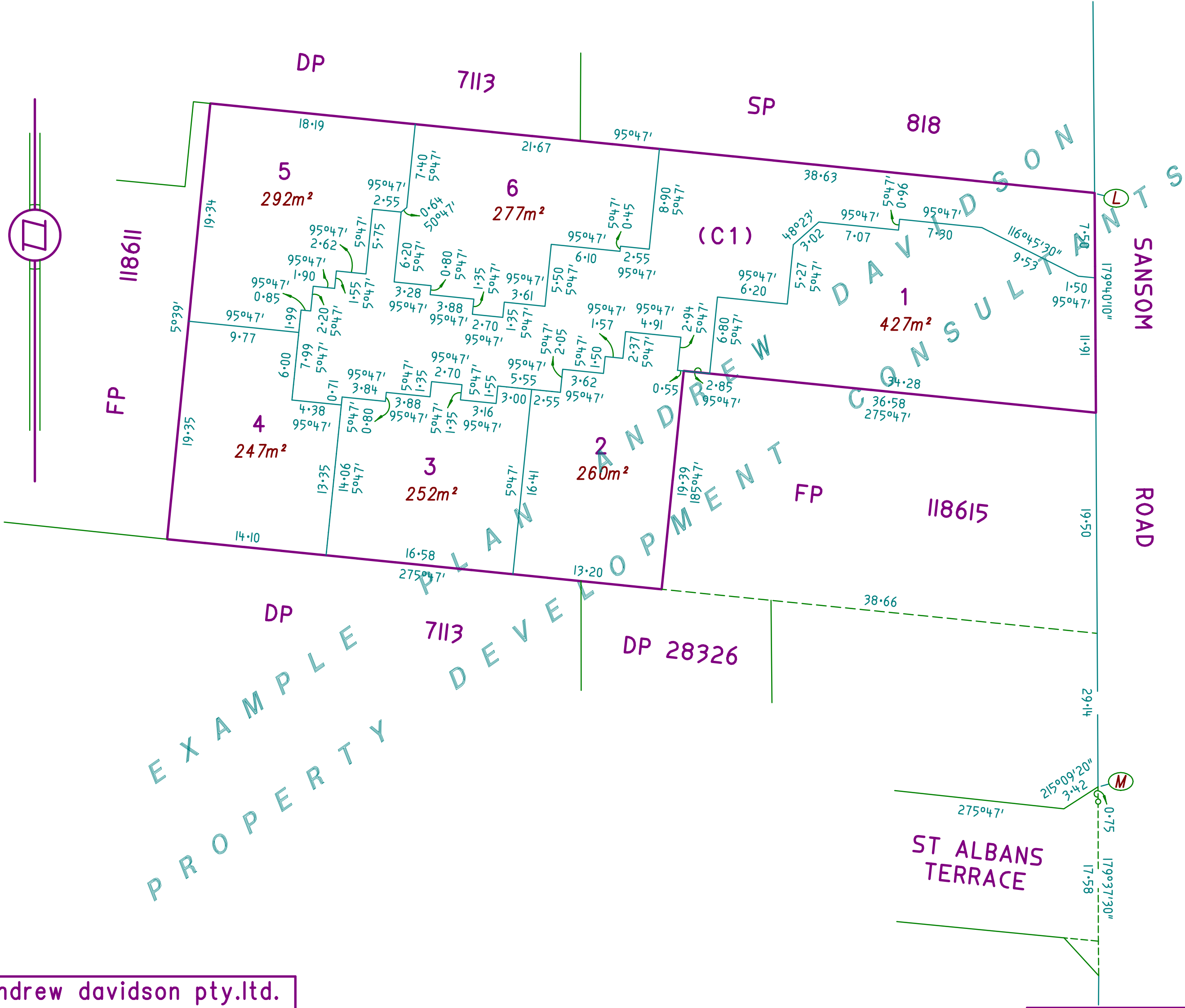

COMMUNITY PLAN NUMBER
CP 22899

PLAN TYPE PRIMARY
THIS IS SHEET 1 OF 2 SHEETS
DEPOSITED / /19 PRO REGISTRAR GENERAL

CLOSURE CHECKED	PLAN EXAMINED	PLAN APPROVED	P.M.S. APPROVED
-----------------	---------------	---------------	-----------------

TITLE REFERENCE CT Volume 5000 Folio 500

LAND DESCRIPTION
ALLOTMENT 32 IN FP 100000
PT. SEC. 500

IRRIGATION AREA — DIVISION —
HUNDRED
AREA **SEMAPHORE PARK**
COUNCIL **CITY OF CHARLES STURT**

MAP REF. 6528/36d DSA —
O.B. FP 46910 TOTAL AREA 2386m²
DEV. No. 252/C000/04



ANNOTATIONS
THE COMMON PROPERTY IS DESIGNATED (C1) FOR LAND INFORMATION PURPOSES ONLY, AND DOES NOT PROVIDE A LEGAL IDENTIFIER FOR THE COMMON PROPERTY.

SERVICE INFRASTRUCTURE NOT LOCATED DUE TO THE NATURE OF THE SCHEME.

ALL DISTANCES ARE GROUND DISTANCES PCPLANS
COMBINED SCALE FACTOR — ZONE — MGA —
BEARING DATUM (L) (M) 179°40'10" DISTANCE
DERIVED FROM ADOPTED FP 46910

CERTIFICATE OF LICENSED SURVEYOR
I, **John CITIZEN**
a licensed Surveyor under the Survey Act 1992, certify that this community plan has been correctly prepared in accordance with the Community Titles Act 1996 to a scale prescribed by regulation,
Dated the 16th day of November 2004
Licensed Surveyor

andrew davidson pty.ltd.
PROPERTY DEVELOPMENT CONSULTANTS
PO Box 654 PH. 83900099 FAX. 83900066
GLENSIDE SA 5065 A.C.N. 007 904 396
admin@andrewdavidson.com.au
16/07/2007 REF: ex

DIRECTION CHANGE (20.32)
PART DISTANCES (20.85 CALC)
CALCULATED DATA (100.85)
COPIED DATA